

PD663 EXPLOSION-PROOF LOOP-POWERED METER



ProtEx™
Lite

- 4-20 mA input
- 1.7 V drop (4.9 V with backlight)
- 3½+ digits LCD, 0.6" high
- Loop-powered backlight option
- Easy four-button programming
- Programmable noise filter
- Max/min display
- Password protection
- HART protocol transparent
- Operates from -40 to 75°C

PRECISION DIGITAL CORPORATION
89 October Hill Road • Holliston MA 01746 USA
Tel (800) 343-1001 • Fax (508) 655-8990

**PRECISION
DIGITAL** 

www.predig.com

Disclaimer

The information contained in this document is subject to change without notice. Precision Digital makes no representations or warranties with respect to the contents hereof; and specifically disclaims any implied warranties of merchantability or fitness for a particular purpose.



CAUTION: Read complete instructions prior to installation and operation of the meter.



WARNING: Risk of electric shock or personal injury.



Warning

This product is not recommended for life support applications or applications where malfunctioning could result in personal injury or property loss. Anyone using this product for such applications does so at his/her own risk. Precision Digital Corporation shall not be held liable for damages resulting from such improper use.

Limited Warranty

Precision Digital Corporation warrants this product against defects in material or workmanship for the specified period under "Specifications" from the date of shipment from the factory. Precision Digital's liability under this limited warranty shall not exceed the purchase value, repair, or replacement of the defective unit.

Registered Trademarks

All trademarks mentioned in this document are the property of their respective owners.

© 2010 Precision Digital Corporation. All rights reserved.

www.predig.com

INTRODUCTION

The ProtEX-Lite PD663 is a rugged, NEMA 4X loop-powered meter in an explosion-proof enclosure ideal for applications where a simple, inexpensive display is required in a hazardous area. The PD663 derives all its power from the 4-20 mA loop. The PD663 is scaled using four push buttons or through the explosion-proof enclosure with optional magnetic reed switches and a magnet key. Scaling can be done without applying an actual calibration signal. The PD663's display will read up to 2999; we call this 3½+ digits! The loop-powered backlighting option lets you see the display under any lighting condition and is powered completely from the 4-20 mA loop. This means there is no need for additional wiring and never any batteries to change.

The PD663 is housed in a rugged, explosion-proof, cast aluminum, NEMA 4X enclosure and is provided with two threaded conduit holes and integrated pipe or wall mounting holes.

ORDERING INFORMATION

Model	Description
PD663-0L0-00	Loop-Powered Meter in Explosion-Proof Enclosure
PD663-0K0-00	Loop-Powered Meter with Backlight in Explosion-Proof Enclosure
PD663-0LA-00	Loop-Powered Meter with Reed Switches in Explosion-Proof Enclosure
PD663-0KA-00	Loop-Powered Meter with Backlight and Reed Switches in Explosion-Proof Enclosure

Accessories

Model	Description
PDA6845	2" Pipe Mounting Kit
PDA-MAG	Magnet Assembly for Reed Switches

Table of Contents

INTRODUCTION -----	3
ORDERING INFORMATION -----	3
SPECIFICATIONS -----	6
General -----	6
Input -----	8
SAFETY INFORMATION -----	9
INSTALLATION -----	10
Unpacking-----	11
Pre-Installed Conduit Plug-----	12
Mounting-----	12
PD663 Connections -----	13
4-20 mA Input Connections & Wiring Diagrams	14
SETUP AND PROGRAMMING -----	15
Buttons and Display -----	16
Main Menu Display Functions & Messages-----	17
Main Menu-----	18
Setting Numeric Values-----	18
Setting Up the Meter -----	19
Programming the Meter	19
Setting the Decimal Point (dP)	20
Scaling the Meter (SL)	21
Calibrating the Meter (RL)	22
Re-calibrating the Internal Calibration Reference (iRL)	23
Advanced Features Menu -----	23
Advanced Features Menu & Display Messages	24
Information Menu ($Info$)	25
Input Signal Filter (IF)	25
Internal Calibration (iRL)	26

OPERATION -----	27
Front Panel Buttons Operation -----	27
Maximum & Minimum Readings (H I & LD)-----	28
Reset Meter to Factory Defaults -----	29
Factory Defaults & User Settings -----	30
TROUBLESHOOTING -----	31
Troubleshooting Tips-----	31
MOUNTING DIMENSIONS -----	32
QUICK USER INTERFACE REFERENCE -----	33

Table of Figures

Figure 1. PD663 Meter Assembly, Rear View	13
Figure 2. PD663 Input Connections without Backlight ...	14
Figure 3. PD663 Input Connections with Backlight.....	14
Figure 4. Enclosure Dimensions – Front View	32
Figure 5. Enclosure Dimensions – Side Section View	32

SPECIFICATIONS

Except where noted all specifications apply to operation at +25°C.

General

DISPLAY	0.6" (15.24 mm) LCD, 3½+ digits; -1999 to 2999
DISPLAY UPDATE RATE	2 Updates/Second
OVERRANGE	Display flashes 2999
UNDERRANGE	Display flashes - 1999
PROGRAMMING METHOD	Four internal pushbuttons, optional magnetic reed switches.
NOISE FILTER	Programmable H I , LO , or OFF
RECALIBRATION	Recalibration is recommended at least every 12 months.
MAX/MIN DISPLAY	Max/Min readings reached by the process are stored until reset by the user or until power to the meter is turned off.
NON-VOLATILE MEMORY	All programmed settings are stored in non-volatile memory for a minimum of ten years if power is lost.
NORMAL MODE REJECTION	64 dB at 50/60 Hz
ENVIRONMENTAL	Operating temperature range: -40 to 75°C Storage temperature range: -40 to 75°C Relative humidity: 0 to 90% non-condensing
CONNECTIONS	Removable screw terminals accept 12 to 22 AWG wire

ENCLOSURE	Explosion-proof die cast aluminum with glass window, 0.30% max copper content, corrosion resistant epoxy coating, color: blue. NEMA 4X, 7, & 9, IP68. Two ½" NPT threaded conduit openings. One ½" NPT nickel plated brass conduit plug with 10 mm hex key fitting installed.
MOUNTING	May be mounted directly to conduit. Two mounting holes for 1.5" pipe or wall mounting. See <i>Mounting Dimensions</i> on page 32.
TIGHTENING TORQUE	Screw terminal electrical connectors: 4.5 lb-in (0.5 Nm)
OVERALL DIMENSIONS	4.84" x 4.29" x 3.62" (123 mm x 109 mm x 92 mm) (W x H x D)
WEIGHT	2.45 lbs (40 oz, 1.13 kg)
WARRANTY	3 years parts and labor

Input

ACCURACY	±1 count	
TEMPERATURE DRIFT	50 PPM/°C from -40 to 75°C ambient	
DECIMAL POINT	User selectable decimal point	
MINIMUM SPAN	Input 1 & Input 2: 0.40 mA	
CALIBRATION RANGE	An <i>Error</i> message will appear if input 1 and input 2 signals are too close together.	
	Input Range	Minimum Span Input 1 & Input 2 4-20 mA 0.40 mA
MAXIMUM VOLTAGE DROP	Without Backlight	With Backlight
	1.7 VDC @ 20 mA	3.7 VDC @ 20 mA
EQUIVALENT RESISTANCE	85 Ω @ 20 mA	185 Ω @ 20 mA
INPUT OVERLOAD	Over current protection to 2 A max.	

Enclosure Ratings and Approvals

FM & CSA

FM Approved & CSA Certified:

Explosion-proof for use in Class I, Division 1, Groups B, C, and D; Dust-Ignition-proof for Class II, Division 1, Groups E, F, and G, Class III; hazardous (classified) locations,

USA: Indoor and outdoor (Type 4X and IP66);

Ta = -40°F to +185°F

FM Certificate: 3028184

Canada: Indoor and outdoor (Type 4X);

Ta = -40°C to +85°C

CSA Certificate: 1726044

ATEX & IECExATEX Certified: Group 2, Category 1 (Zone 1),
Gases, Vapors, Mists, or Dusts: II 2 G D

Ex d IIC

Ex tD A21 IP68

Ta = -40°C to +85°C

ATEX Certificate: Sira 07ATEX1331U

IECEx Certified: Flameproof, Gas Group IIC

Ex d IIC

Ex A21 tD IP68

Ta = -40°C to +85°C

IECEx Certificate: IECEx SIR 07.0111U

Year of Construction

This information is printed on the enclosure label.

SAFETY INFORMATION



CAUTION: Read complete instructions prior to installation and operation of the meter.

Installation and service should be performed only by trained service personnel. Service requiring replacement of internal components must be performed at the factory.

INSTALLATION

For Installation in USA: The PD663 must be installed in accordance with the National Electrical Code (NEC) NFPA 70.

For Installation in Canada: The PD663 must be installed in accordance with the Canadian Electrical Code CSA 22.1.

For European Community: The PD663 must be installed in accordance with the ATEX directive 94/9/EC and the enclosure certificates ATEX Certificate: Sira 07ATEX1331U, IECEx Certificate: IECEx SIR 07.0111U.

All pushbuttons and wiring connectors are accessed by opening the enclosure. To access electrical connectors, remove the 2 captive screws and remove the meter assembly. Pushbuttons may also be accessed using the magnet assembly if reed switches are installed.



CAUTION: Disconnect from supply before opening enclosure. Keep cover tight while circuits are alive. Conduit seals must be installed within 18" of the enclosure.

Unpacking

Remove the meter from box. Inspect the packaging and contents for damage. Report damages, if any, to the carrier.

If any part is missing or the meter malfunctions, please contact your supplier or the factory for assistance.

Pre-Installed Conduit Plug

The PD663 is supplied with one pre-installed optional conduit plug for installations that do not require the use of both conduit entries. The conduit plug includes an internal hexagonal socket recess for removal. The pre-installed plug and installation are included in all hazardous area approvals of the PD663.



CAUTION: Installations of the supplied conduit plug require the application of non-setting (solvent free) thread sealant. If the pre-installed conduit plug is removed or replaced all relevant hazardous area guidelines must be followed for its installation or replacement conduit.

Mounting

The PD663 has two mounting holes that may be used for a 1.5" pipe mounting or wall mounting. Alternatively, the unit may be supported by the conduit using the conduit holes provided.

It can also be pipe mounted by using the PDA6845 pipe mount kit for 2" pipe.

Refer to *Mounting Dimensions*, page 32 for details on wall or panel space requirements

PD663 Connections

To access the connectors, remove the enclosure cover and unscrew the two captive stainless steel screws. Remove the meter assembly from the enclosure. Signal connections are made to a three-terminal removable connector on the back of the meter assembly. Grounding connections are made to the two ground screws provided on the base – one internal and one external.

S+ 4-20 mA signal input positive terminal connection

S- 4-20 mA signal return/negative terminal connection

X Not connected (no backlight option)

B- 4-20 mA signal return/negative terminal when using the installed loop powered backlight option

See Figure 1 for terminal positions on the rear of the meter assembly.



Observe all safety regulations. Electrical wiring should be performed in accordance with all agency requirements and applicable national, state, and local codes to prevent damage to the meter and ensure personnel safety.



Figure 1. PD663 Meter Assembly, Rear View

4-20 mA Input Connections & Wiring Diagrams

Signal input connections are made to a three-terminal connector labeled S+|S-|X for models without a backlight and S+|S-|B- for models with a backlight. The enclosure also provides one internal and one external earth grounding screw. The 4-20 mA input with no backlight has a maximum voltage drop of 1.7 V and is wired as shown in Figure 2. The loop-powered backlight configuration requires a total maximum voltage drop of 3.7 V. The backlight is recommended for dim lighting conditions and is enabled when wired as shown in Figure 3. The enclosure also provides one internal and one external earth grounding screw.

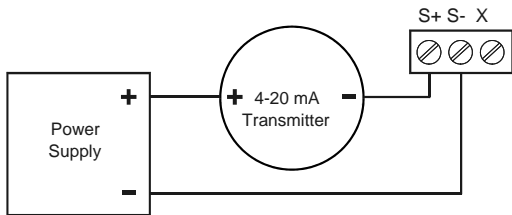

Figure 2. PD663 Input Connections without Backlight

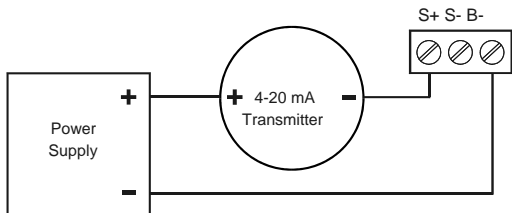

Figure 3. PD663 Input Connections with Backlight

SETUP AND PROGRAMMING

There is **no need to recalibrate** the meter for milliamps when first received from the factory.

The meter is **factory calibrated** for milliamps prior to shipment. The calibration equipment is certified to NIST standards.

Overview





There are no jumpers involved in the setup process of the meter. Setup and programming is done through the front panel buttons.

After all connections have been completed and verified, apply power to the loop.

For
Quick User Interface Reference
go to page 33

Buttons and Display



Button/ Symbol	Description
 MENU	Menu button to enter programming mode. Press and hold for 5 seconds to access the <i>Advanced</i> features of the meter.
 ENTER	Enter button to access a menu or accept a setting.
 RESET	Right arrow to scroll through the menus or move to the next digit or decimal position during programming. Resets the Max or Min display value when pressed while showing Max or Min value.
 MAX	Up arrow to scroll through the menus, decimal point, or to increment the value of a digit. Displays the Max then Min display values when pressed during normal run mode.

Main Menu Display Functions & Messages

The meter displays various functions and messages during setup, programming, and operation. The following table shows the main menu functions and messages in the order they appear in the menu.

Display	Parameter	Action/Setting
dP	<i>Decimal point</i>	Set decimal point
$5[L$	<i>Scale</i>	Enter the <i>Scale</i> menu
$m i$	<i>Scale Input 1</i>	Input signal 1 value (mA)
$d i$	<i>Scale Display 1</i>	Scaled value for input 1
$m 2$	<i>Scale Input 2</i>	Input signal 2 value (mA)
$d 2$	<i>Scale Display 2</i>	Scaled value for input 2
$[RL$	<i>Calibrate</i>	Enter the <i>Calibrate</i> menu
$m i$	<i>Calibrate Input 1</i>	Read input signal 1
$d i$	<i>Calibrate Display 1</i>	Enter value for input 1
$m 2$	<i>Calibrate Input 2</i>	Read input signal 2
$d 2$	<i>Calibrate Display 2</i>	Enter value for input 2

Main Menu

The main menu consists of the most commonly used functions:
Decimal Point Location, Scale, and Calibration.

Press **Menu** button to enter Programming Mode then press the **Up Arrow** button to scroll main menu.

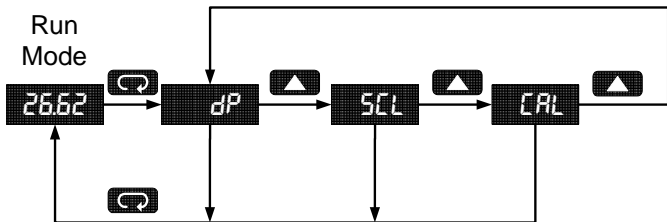

Press **Menu**, at any time, to exit and return to Run Mode. Changes made to settings prior to pressing **Enter** are not saved. Changes to the settings are saved to memory only after pressing **Enter**.

The display moves to the next menu every time a setting is accepted by pressing **Enter**.

Setting Numeric Values

The numeric values are set using the **Right** and **Up** arrow buttons. Press **Right** arrow to select next digit and **Up** arrow to increment digit. The two left-most digits on the display are set as a single digit, able to display -19 to 29.

The digit being changed blinks.

Press the **Enter** button, at any time, to accept a setting or **Menu** button to exit without saving changes.

The decimal point is set using the **Right** or **Up** arrow button in the *Setup-decimal point* menu.

Setting Up the Meter

Press the **Enter** button to access any menu or press **Up** arrow button to scroll through choices. Press the **Menu** button to exit at any time.

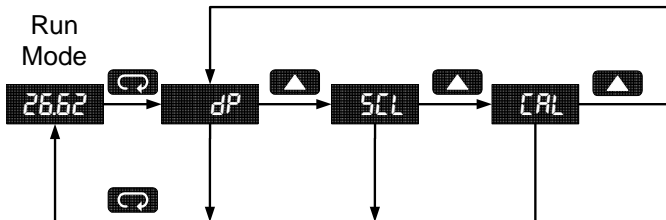

Programming the Meter

It is **very important** to read the following information, before proceeding to program the meter:

There is **no need to recalibrate** the meter for milliamps when first received from the factory.

The meter is **factory calibrated** for milliamps prior to shipment. The calibration equipment is certified to NIST standards.

Use the *Scale* (SCL) menu to enter scale parameters without applying a live signal.

Alternatively, use the *Calibrate* (CAL) menu to apply a signal from a calibrator or a 4-20 mA transmitter to calibrate the meter.

Inputs may be calibrated or scaled to any display within the range of the meter.

Additional parameters, not needed for most applications, are viewed and programmed with the *Advanced* features menu, see Advanced Features Menu, page 24.

Minimum Input Span

The minimum input span is the minimum difference between input 1 and input 2 signals required to complete the calibration or scaling of the meter. The minimum span is 0.40 mA.

If the minimum span is not maintained, the meter reverts to input 2, allowing the appropriate input signals to be applied.

Setting the Decimal Point (dP)

Decimal point may be set with up to three decimal places or with no decimal point at all.

Pressing the **Right** or **Up** arrow moves the decimal point one place to the right until no decimal point is displayed, then it moves to the left most position.

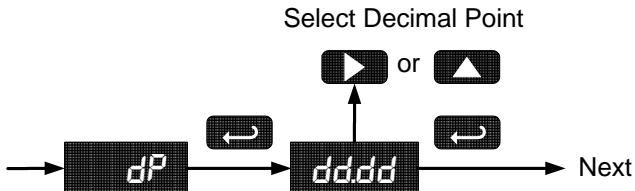

Scaling the Meter (SCL)

The 4-20 mA input can be scaled to display the process in engineering units.

A signal source is not needed to scale the meter; simply program the inputs and corresponding display values.

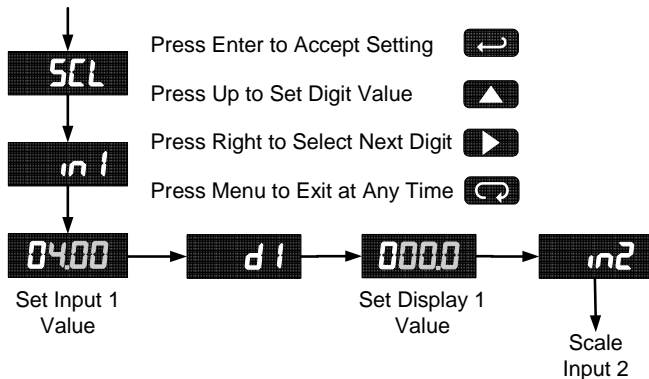

For instructions on how to program numeric values see *Setting Numeric Values*, page 18.

Calibrating the Meter (CAL)

To scale the meter without a signal source refer to *Scaling the Meter (5EL)*, page 21.

The meter can be calibrated to display the process in engineering units by applying the appropriate input signal and following the calibration procedure.

The use of a calibrated signal source is strongly recommended.

Press Enter to Accept Setting 

Press Up to Set Digit Value 

Press Right to Select Next Digit 

Press Menu to Exit at Any Time 

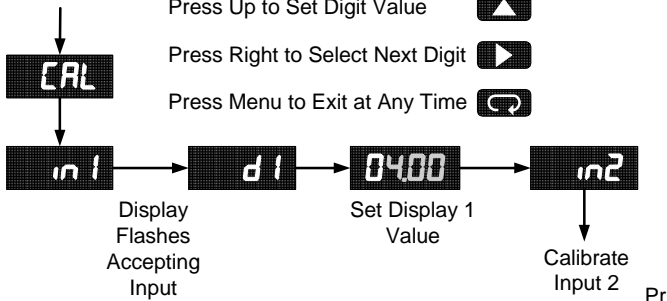

Press the **Up** arrow button to scroll to the *Calibration* menu (CAL) and press **Enter**.

The meter displays *in 1*. Apply a known signal and press **Enter**. The display will flash while accepting the signal.

After the signal is accepted, the meter displays *d 1*. Press **Enter**. Enter a corresponding display value for the signal input, and press **Enter** to accept.

The meter displays *in 2*. Apply a known signal and press **Enter**. The display will flash while accepting the signal.

After the signal is accepted, the meter displays *d 2*. Press **Enter**. Enter a corresponding display value for the signal input and press **Enter** to accept.

Re-calibrating the Internal Calibration Reference (ICRL)

The *Internal Calibration* (ICRL) menu, located in the *Advanced* features menu, is used to recalibrate the internal calibration reference. Recalibration is recommended at least every twelve months. Refer to *Internal Calibration* (ICRL), page 26 for instructions.

Advanced Features Menu

To simplify the setup process, functions not needed for most applications are located in the *Advanced* features menu. Press and hold the **Menu** button for five seconds to access the *Advanced* features menu



Advanced Features Menu & Display Messages

The following table shows the *Advanced* features menu functions and messages in the order they appear in the menu.

Display	Parameter	Action/Setting
INFO	<i>Information</i>	Enter the <i>Information</i> menu
SFE	<i>Software Information</i>	Software release number
VER	<i>Version</i>	Meter firmware version
°C	<i>Calibration Temp (°C)</i>	Temperature at time of I-calibration (°C)
°F	<i>Calibration Temp (°F)</i>	Temperature at time of I-calibration (°F)
FIL	<i>Filter</i>	Set filter function level
ICAL	<i>I-Calibration</i>	Internal master factory calibration
RESET	<i>Reset Defaults</i>	Restore factory default parameter settings

For instructions on how to program numeric values see <i>Setting Numeric Values</i> , page 18.
--

Information Menu (info)

The *Information* menu is located in the *Advanced* features menu, to access *Information* menu see *Advanced Features Menu*, page 23.

It shows software identification number, version number, and calibration temperatures. To determine the software version of a meter:

Go to the *Information* menu (*INF*) and press **Enter** button.

The meter will automatically scroll through the software release number and software version. The meter temperatures at the time of last internal calibration in °C and °F are displayed for calibration troubleshooting. Pressing the **Enter**, **Right**, or **Up** buttons will progress the information display.

Following the information display, the meter will exit the *Advanced* features menu and return to run mode.

Input Signal Filter (F IL)

The noise filter is available for unusually noisy signals that cause an unstable process variable display. The noise filter averages the input signal over a certain period. The filter level can be set to low (*LD*), high (*HI*), or off (*OFF*). The higher the filter setting, the longer the averaging time and so the longer the display may take to find its final value.

The filter contains a noise filter bypass feature so that while small variations in the signal will be filtered out, large, abrupt changes to the input signal are displayed immediately.

Internal Calibration (*ICRL*)

There is **no need to recalibrate** the meter for milliamps when first received from the factory.

The meter is **factory calibrated** for milliamps prior to shipment. The calibration equipment is certified to NIST standards.

The internal calibration allows the user to scale the meter without applying a signal. The use of a calibrated signal source is necessary to perform the internal calibration of the meter. Check calibration of the meter at least every 12 months.

Notes:

The signal source must have a full-scale accuracy of 0.01% or better between 4 and 20 mA in order to maintain the specified accuracy of the meter.

Allow the meter to warm up for at least 15 minutes before performing the internal calibration procedure.

The *Internal calibration* menu is part of the *Advanced* features menu.

Press and hold the **Menu** button for 5 seconds to enter the *Advanced* features menu. Press the **Up** arrow button to scroll to the *Internal Calibration* menu (*ICRL*) and press **Enter**.

The meter displays 4.00 mA. Apply a 4.00 mA signal and press **Enter**. The display flashes for a moment while the meter is accepting the signal.





After the signal is accepted, the meter displays 20.00 mA. Apply a 20.00 mA signal and press **Enter**. The display flashes for a moment while the meter is accepting the signal.

Error Message (*Err*)

An error message indicates that the calibration process was not successful. After the error message is displayed, the meter will revert to input 2 calibration settings. The error message might be caused by inadvertently leaving the signal at the previous level or not maintaining a 0.40 mA minimum span. Press the Menu button to cancel the current calibration process if necessary.

OPERATION

Front Panel Buttons Operation

Button Symbol	Description
 MENU	Press to enter or exit Programming Mode or exit Max/Min readings.
 ENTER	Press to indefinitely display Max or Min until Menu button is pressed.
 RESET	Press to reset Max or Min reading.
 MAX	Press to display Max/Min readings alternately.

Maximum & Minimum Readings (HI & LO)

The maximum and minimum (peak & valley) readings reached by the process are stored in the meter since the last reset or power-up. The meter flashes **HI** or **LO** to differentiate between run mode and max/min display.

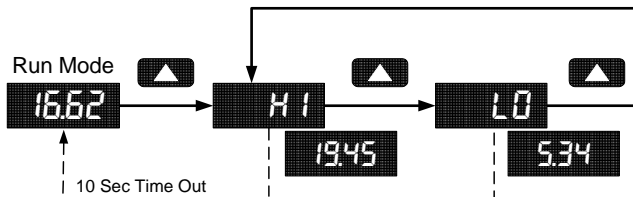

Press **Up** to Display and to
Toggle Between Max & Min



Press **Enter** to Hold Max/Min



Press **Right** to Reset Max/Min



Press **Menu** to Exit Max/Min



Press **Up** arrow button to display maximum reading since the last reset/power-up.

Press **Up** arrow again to display the minimum reading since the last reset/power-up.

Press **Enter** to continue to display the Max or Min display reading by disabling the Max/Min timeout. The meter will continue to track new Max/Min readings. Press MENU to exit the Max/Min reading.

If **Enter** is not pressed, the Max/Min display reading will continue to flash and time out after ten seconds. The meter will return to display the actual reading.

Press **Right** arrow button while in Max/Min Mode to reset both Max and Min. Max/Min display readings are reset to the current reading.

Reset Meter to Factory Defaults

When the parameters have been changed in a way that is difficult to determine what's happening, it might be better to start the setup process from the factory defaults.

Instructions to load factory defaults:

Enter the *Advanced* features menu. See Advanced Features Menu, page 23.

Press **Right** arrow button when `inFo` is shown.

Press **Enter** button when `rSt` is shown.

Press **Enter** again when display flashes `rSt`.

Note: If **Enter** is not pressed a second time within three seconds, `rSt` will stop flashing and the last **Enter** press cancelled.

The meter goes through an initialization sequence (same as on power-up), and loads the factory default settings.

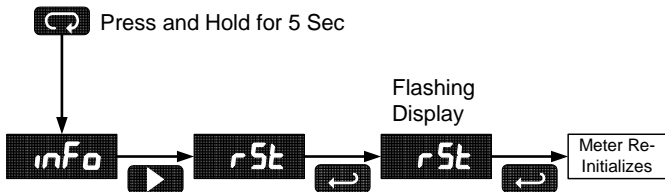

Factory Defaults & User Settings

The following table shows the factory setting for most of the programmable parameters on the meter. Next to the factory setting, the user may record the new setting for the particular application.

Model: _____

S/N: _____ Date:

Parameter	Display	Default Setting	User Setting
<i>Decimal point</i>	<i>ddd.d</i>	2 places	
<i>Scale</i>	<i>5LL</i>		
<i>Input 1</i>	<i>in 1</i>	4.00 mA	
<i>Display 1</i>	<i>d 1</i>	4.00	
<i>Input 2</i>	<i>in 2</i>	20.00 mA	
<i>Display 2</i>	<i>d 2</i>	20.00	
<i>Advanced Features</i>			
<i>Filter</i>	<i>F IL</i>	Off	

TROUBLESHOOTING

The rugged design and the user-friendly interface of the meter should make it unusual for the installer or operator to refer to this section of the manual. If the meter is not working as expected, refer to the recommendations below.

Troubleshooting Tips

Symptom	Check/Action
No display or faint display	Check input signal connections. Perform hard reset by shorting S+ and S- terminals.
Rate display unsteady	Increase filter setting in <i>Advanced</i> menu.
Meter displays error message during calibration (<i>Err</i>)	Check signal connections. Verify minimum input span requirements
Meter flashes 2999 or -1999	Check input signal within scaled range of 2999 and -1999.
Display stuck flashing a number and <i>H I</i> or <i>L U</i>	Press Menu to exit Max/Min display readings.
Display response is too slow	Check filter setting to see if it can be lowered to <i>L U</i> or <i>OFF</i> .
If the display locks up or the meter does not respond at all	Perform hard reset by shorting S+ and S- terminals.
Backlight does not appear.	Verify backlight is installed. Check signal connections are as shown in Figure 3 on page 14.
Other symptoms not described above	Call Technical Support for assistance.

MOUNTING DIMENSIONS

All units: inches [mm]

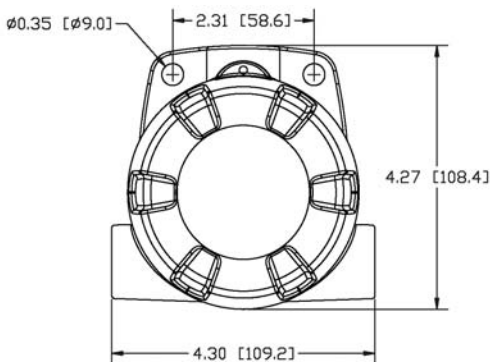

Figure 4. Enclosure Dimensions – Front View

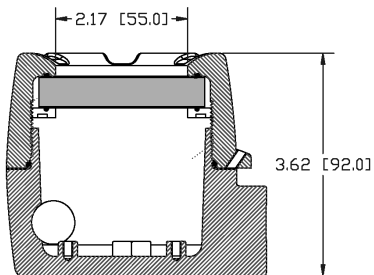

Figure 5. Enclosure Dimensions – Side Cross Section View

Note: The supplied conduit plug may extend up to 0.6 in [15 mm] from the conduit opening when installed.

QUICK USER INTERFACE REFERENCE

<u>Pushbutton</u>	<u>Function</u>
Menu	Go to Programming Mode, leave Programming Mode, and Max/Min Mode. Hold for 5 seconds to access <i>Advanced Features</i> .
Right Arrow	Move to next digit or decimal point position. Reset Min/Max.
Up Arrow	Move to next selection or increment digit. Go to Max/Min Mode.
Enter	Accept selection/value and move to next selection.

Max/Min Mode

While in Run Mode, pressing **Up Arrow** will initiate Max/Min Mode. **Up Arrow** toggles between Max & Min displays, and **Right Arrow** resets the Max/Min to the current value. Press **Menu** or wait 10 seconds to return to Run Mode. Pressing **Enter** will disable the 10 second timeout and continuously flash Max or Min.

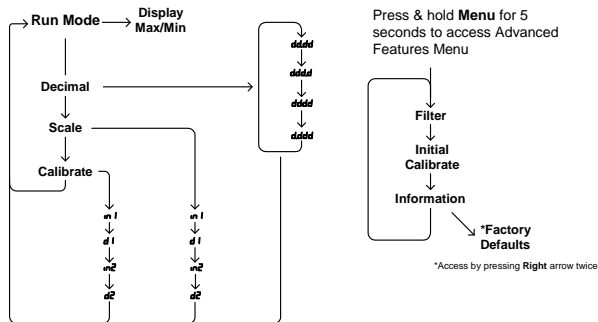

Operational Modes

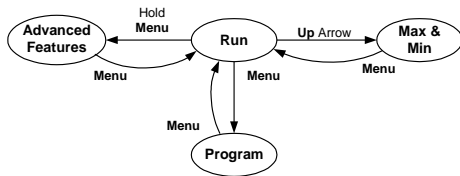

How to Contact Precision Digital

- For Technical Support:
Call: (800) 610-5239 or (508) 655-7300
Fax: (508) 655-8990
Email: support@predig.com
- For Sales Support:
Call: (800) 343-1001 or (508) 655-7300
Fax: (508) 655-8990
Email: sales@predig.com
- For the latest version of this manual please visit:
www.predig.com

The logo for Precision Digital, featuring the words "PRECISION" and "DIGITAL" in a bold, sans-serif font, stacked vertically. To the right of "DIGITAL" is a small square icon containing a crosshair symbol. The entire logo is set against a black rectangular background with a thin white border.