

LOW PRESSURE GAUGES

Low Pressure Gauges

Accurate and reliable low pressure gauges available in 4 1/2" Dyna-mount cases and stainless steel cases.

Features:

- Adjustable Dyna-mount fitting and flange
- Adjustable zero setting
- Standard changeable filter
- All Wetted surfaces stainless steel construction
- 150 % Overpressure with no effect on calibration
- 500 % Burst pressure
- Design tested to 500,000 cycles
- Ranges available from 0-25 inches of water (60 mbar) to 15 psig (1000 mbar)
- Fitting size changeable in the field

Benefits:

- Application flexibility, bottom or back mount in one unit
- Longer service life
- Rezero capability
- Corrosion resistance

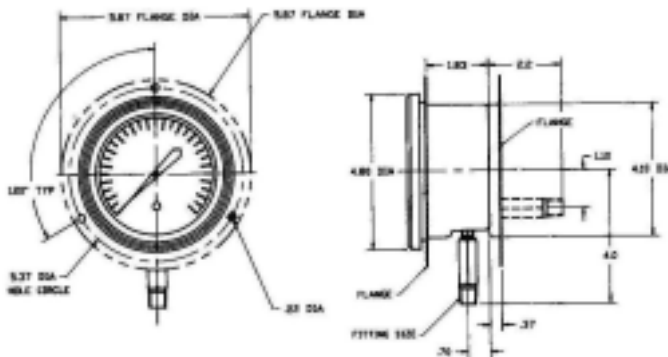

STAINLESS STEEL CASE

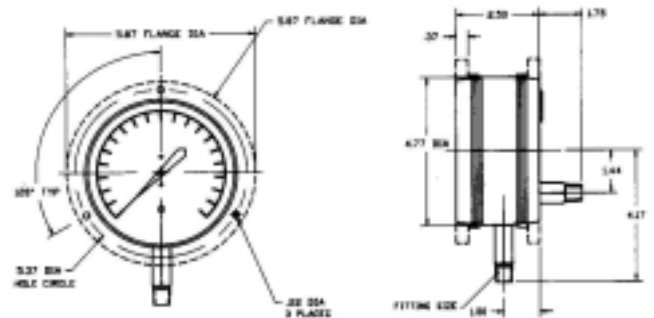

PLASTIC CASE

The "Direct Drive Difference"

Pressure Ranges: 25 inches (60 mbar) of water to 15 psig (1000 mbar)

Accuracy: +/-2.0% of full scale + 1.0 %*

Ambient Temperature: -65°F to 190°F (-54°C to 88°C)

Proof Pressure: 150 % full scale no calibration shift

Burst Pressure: 500 % of full scale

Operating Media: Any gas media suitable for contact with 316 stainless steel

MATERIALS

Sensing Element: Stainless steel
 Fitting: 316 stainless steel
 Dial: 300 series stainless steel
 Movement: Brass

STAINLESS STEEL CASE MATERIALS

Case: 300 series stainless steel electro-polished
 Crystal: Acrylic (or optional glass)
 Flange: 300 series stainless steel (Optional)

HIGH IMPACT PLASTIC CASE MATERIALS

Case: High impact resistant Cycolac Plastic
 Crystal: Acrylic
 Flange: High impact resistant

* Consult factory for price and delivery

MOD CODE LISTING

None - "psig" and "in H₂O" ranges / scales
 "ISZ" - "oz/in²" ranges / scales
 "ISB" - "mbar" or "bar" ranges / scales
 "ISO" - "kPa" ranges / scales
 "ISK" - "kgf/cm²" and "mm H₂O" ranges / scales
 "ISZD" - Dual scale with "oz/in²" inner scale and "psig" or "in H₂O" outer scale
 "ISBD" - Dual scale with "mbar" inner scale and "psig" or "in H₂O" outer scale
 "ISOD" - Dual scale with "kPa" inner scale and "psig" or "in H₂O" outer scale
 "ISKD" - Dual scale with "kgf/cm²" or "mm H₂O" inner scale and "psig" / "in H₂O" outer scale
 "CPB" - 0 to 100 % linear scale for receiver gauge
 "CPA" - 0 to 10 square root scale for receiver gauge
 "GCG" - Optional 1.0 % (of Span) Accuracy
 "GBT" - Optional Laminated Glass Crystal (Stainless Steel Case Only)

Note: More than one Mod Code can be used at the end of the model number.

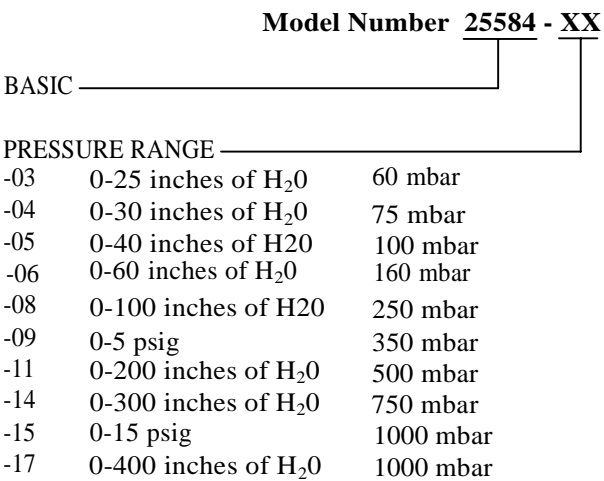

ORDERING INFORMATION

CASE

- 1 = black ABS Plastic
- 4 = yellow ABS Plastic
- 5 = stainless steel

FLANGE / FITTING POSITION

- 1 = front / bottom
- 2 = front / back
- 3 = none / back
- 4 = back / back
- 5 = none / bottom
- 7 = detached / bottom (ABS only)
- 8 = detached / back (ABS only)

FITTING

- B = 1/4 NPTM
- C = 1/2 NPTM

• All metric gauges are standard per ASME B40.1



15542 Chemical Lane, Huntington Beach, CA 92649, USA * 714/894-5351 * FAX 714/895-4309

©1991 3D Instruments, LLC Printed in U.S.A. 3D Precision Test Gauges

Web Site <http://www.3dinstruments.com>

ALL INFORMATION CONTAINED HEREIN IS UNCLASSIFIED EXCEPT WHERE SHOWN OTHERWISE BY INDICATED BY THE PROPERTY OF 3M INTELLECTUAL PROPERTY. ALL INFORMATION CONTAINED HEREIN IS UNCLASSIFIED EXCEPT WHERE SHOWN OTHERWISE BY INDICATED BY THE PROPERTY OF 3M INTELLECTUAL PROPERTY. ALL INFORMATION CONTAINED HEREIN IS UNCLASSIFIED EXCEPT WHERE SHOWN OTHERWISE BY INDICATED BY THE PROPERTY OF 3M INTELLECTUAL PROPERTY.

REVIEWS			
DATE	BY	CHK	APPROV
1.0	3.0.004	C.C.	
4	PRODUCTION RELEASE		

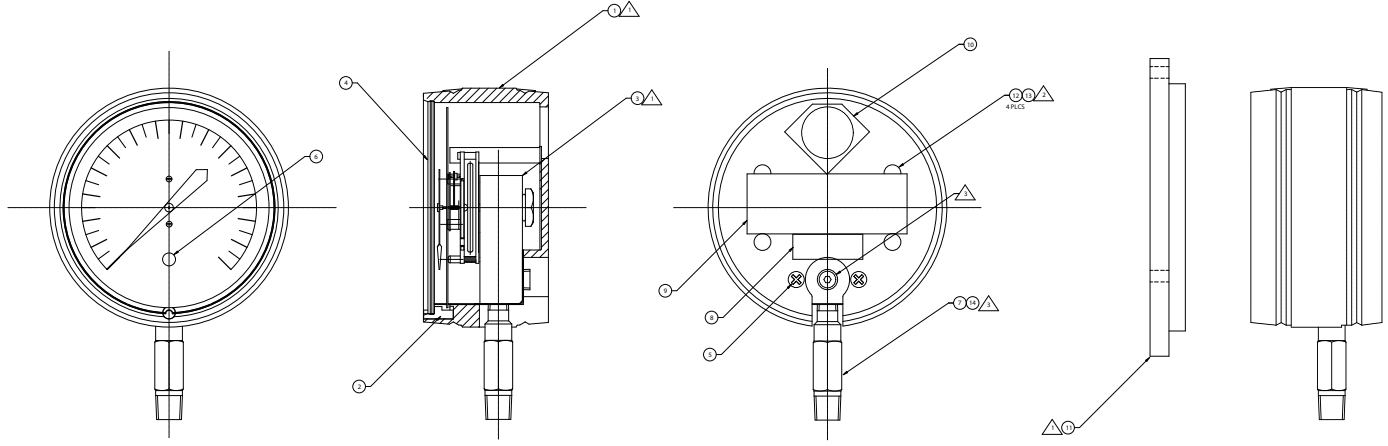

NUMBER DEFINITION:

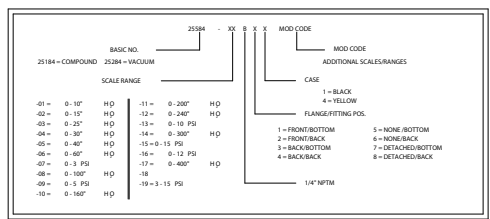

SCALE RANGE TABULATION CHART

DASH NO.	ITEM 3	REF. SCALE
-01	4120-0001-01	0 - 10" H ₂ O
-02	4120-0001-02	0 - 15" H ₂ O
-03	4120-0001-03	0 - 25" H ₂ O
-04	4120-0001-04	0 - 30" H ₂ O
-05	4120-0001-05	0 - 40" H ₂ O
-06	4120-0001-06	0 - 60" H ₂ O
-07	4120-0001-07	0 - 3 PSI
-08	4120-0001-08	0 - 100" H ₂ O
-09	4120-0001-09	0 - 5 PSI
-10	4120-0001-10	0 - 160" H ₂ O
-11	4120-0001-11	0 - 200" H ₂ O
-12	4120-0001-12	0 - 240" H ₂ O
-13	4120-0001-13	0 - 10 PSI
-14	4120-0001-14	0 - 300" H ₂ O
-15	4120-0001-15	0 - 15 PSI
-16	4120-0001-16	0 - 15 PSI
-17	4120-0001-17	0 - 400" H ₂ O
-18		
-19	4120-0001-19	0 - 15 PSI

- 1. LOCATE PLUG AND FITTING FOR BACK CONNECT.
- 2. REPAIR 2-PART EPOXY, ITEM 13 AND APPLY IT TO ITEM 12 AS REQUIRED. ALLOW SUFFICIENT TIME TO CURE PRIOR ASSY.
- 3. REFER TO NUMBER DEFINITION FOR 'X' UNDER 'CASE' OR 'XX' UNDER 'SCALE RANGE', WHEN APPLICABLE.

NOTES:

QTY	REV	DESCRIPTION	DATE	BY	CHK	APPROV
15						
14		TELON TAPE				
14		PP 750				
12		2138-0044-X				
11		20640087				
10		2124-0081				
9		2124-0073				
8		2124-0076				
7		2063-0186				
6		2038-0056				
5		2154-0091-S7				
4		2061-0048				
3		4120-0001-XX				
2		2155-0075-X				
1		80290024				

QUANTITY	REVISION	DESCRIPTION	DATE	BY	CHK	APPROV
12						
11						
10						
9						
8						
7						
6						
5						
4						
3						
2						
1						

DATE	BY	CHK	APPROV
11/14/19	C. COLLIER	A. HAZEL	

DATE	BY	CHK	APPROV
11/14/19	C. COLLIER	A. HAZEL	

DATE	BY	CHK	APPROV
11/14/19	C. COLLIER	A. HAZEL	

DATE	BY	CHK	APPROV
11/14/19	C. COLLIER	A. HAZEL	

DATE	BY	CHK	APPROV
11/14/19	C. COLLIER	A. HAZEL	

3M INTELLECTUAL PROPERTY

GAUGE ASSEMBLY

LOW PRESS. PLASTIC 1/4" FTG.

D 52159

25584-XXBXX

