



03627E00

Inspection Light Series 6149

- Extremely long service life due to cold cathode tubes used
- Also suitable for machine lighting
- Anti-roll design in the grip
- Lockable suspension hooks
- 2 lamp or 4 lamp version
- For 110 V ... 230 V or 24 V ... 48 V

Selection Table						
Version	Nominal voltage	Temperature class at T _a =		T _{O max.} at T _a = 40 °C	Order number	Weight kg
		40 °C	50 °C			
Inspection light 6149, 2 lamps	24 V ... 48 V AC / DC	T4	T4	105 °C	6149/1-312-1200	1.155
	110 V ... 230 V AC; 50 / 60 Hz	T4	T4	110 °C	6149/1-511-1200	1.155
Inspection light 6149, 4 lamps	24 V ... 48 V AC / DC	T4	--	110 °C	6149/1-322-1200	1.200
	110 V ... 230 V AC; 50 / 60 Hz	T4	--	120 °C	6149/1-521-1200	1.200
Order Number Supplement						
Wire guard	without wire guard				6149/1-...-...0	
	with wire guard				6149/1-...-...1	
Note	- The inspection light is delivered with a 5 m connecting cable (other lengths on request) - The inspection light is delivered without plug and wire guard. Specify the plug on order (see Accessories an Spare Parts).					

Technical Data		
Version	6149/1-1 (2 lamps)	6149/1-2 (4 lamps)
Explosion protection		
Gas explosion protection	⊕ II 2 G Ex d IIC T4	⊕ II 2 G Ex d IIC T4
Dust explosion protection	⊕ II 2 D Ex tD A21 IP6X T _{O max} *	⊕ II 2 D Ex tD A21 IP6X T _{O max} *
	* surface temperatures see selection table	* surface temperatures see selection table
Certificates	PTB 07 ATEX 1009	PTB 07 ATEX 1009
Other certificates	IECEX, Belarus (Promatomnadzor)	IECEX, Belarus (Promatomnadzor)
Rated operational voltage	24 V ... 48 V AC / DC ± 10 %; 50 / 60 Hz 110 V ... 230 V AC ± 10 %; 50 / 60 Hz	24 V ... 48 V AC / DC ± 10 %; 50 / 60 Hz 110 V ... 230 V AC ± 10 %; 50 / 60 Hz
Nominal operational current	24 V AC / DC 0.6 A 42 V AC / DC 0.4 A 48 V AC / DC 0.35 A 110 V AC 0.074 A 230 V AC 0.044 A	24 V AC / DC 1.1 A 42 V AC / DC 0.67 A 48 V AC / DC 0.6 A 110 V AC 0.135 A 230 V AC 0.07 A
Ambient temperature	- 20 °C ... + 50 °C	- 20 °C ... + 40 °C
Lamps	2 x CCFL 320 mm, cold cathode lamps	4 x CCFL 320 mm, cold cathode lamps
Light intensity	130 lux in 1 m distance	205 lux in 1 m distance
Luminous flux	approx. 400 lm	approx. 800 lm
Type of Protection	IP66/67	IP66/67
Protection class	II	II
Material		
Enclosure pipe	Polycarbonate	Polycarbonate
Grip	Aluminium	Aluminium
Sealing cap	Aluminium	Aluminium
Rubber grip	NBR / PVC (EPDM)	NBR / PVC (EPDM)
Suspension hook	NBR / PVC (EPDM)	NBR / PVC (EPDM)
Connecting cable	Standard: connecting cable, 5 m, Type H07RN-F, Ø 7.7 ... 10 mm, 2 x 1 mm ² Optional: Gifas Thermoflex cable, 5 m, Type HXSLHXÖ-J, d 7.7 ... 10 mm, 2 x 1.5 mm ² Helukabel with steel wire screening, Type SY-JZ, 2 x 1.5 mm ²	Standard: connecting cable, 5 m, Type H07RN-F, Ø 7.7 ... 10 mm, 2 x 1 mm ² Optional: Gifas Thermoflex cable, 5 m, Type HXSLHXÖ-J, d 7.7 ... 10 mm, 2 x 1.5 mm ² Helukabel with steel wire screening, Type SY-JZ, 2 x 1.5 mm ²
Cable glands	Standard: 8163/2-20S-A2F-M20, M20 x 1.5, Ø 6.1 mm ... 11.7 mm Optional: 8163/2-20S-E1FXZ-M20, M20 x 1.5, Ø 6.1 mm ... 11.6 mm	Standard: 8163/2-20S-A2F-M20, M20 x 1.5, Ø 6.1 mm ... 11.7 mm Optional: 8163/2-20S-E1FXZ-M20, M20 x 1.5, Ø 6.1 mm ... 11.6 mm

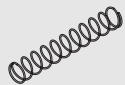
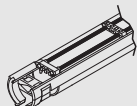
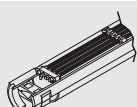
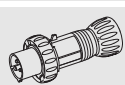
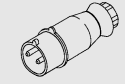
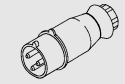
Accessories and Spare Parts				
Designation	Illustration	Description	Order number	Weight kg
Mounting bracket	 04880E00	Mounting bracket galvanised	120535	0.050
Mounting bracket and magnet	 04885E00	Mounting bracket of galvanised sheet steel and magnet	120536	0.100
Wire guard	 04888E00	Stainless steel wire guard for additional mechanical protection	120509	0.170
Lamp holder with lamps, 2 lamps	 04889E00	for 6149/1-51-200 (110 V ... 230 V AC; 50 / 60 Hz)	120519	0.190
		for 6149/1-312-1200 (24 V ... 48 V AC / DC; 50 / 60 Hz)	167506	0.190
Lamp holder with lamps, 4 lamps	 04890E00	for 6149/1-52-200 (110 V ... 230 V AC; 50 / 60 Hz)	120524	0.190
		for 6149/1-322-1200 (24 V ... 48 V AC / DC; 50 / 60 Hz)	167511	0.190
Plug	 04923E00	8570/12-304 3 pins, 100 - 130 V, 50/60 Hz, 16 A	150599	0.420
		8570/12-306 3 pins, 200 - 250 V, 50/60 Hz, 16 A	150579	0.420
	 04922E00	8575/12-100 2 pins, 20 - 25 V, 16 A	151545	0.220
		8575/12-110 2 pins, 20 - 25 V DC, 16 A	151553	0.220
	 12214E00	8575/12-200 3 pins, 20 - 25 V, 16 A	151486	0.230
		8575/12-212 3 pins, 40 - 50 V, 16 A	151496	0.220

Dimensional Drawings (All Dimensions in mm) - Subject to Alterations

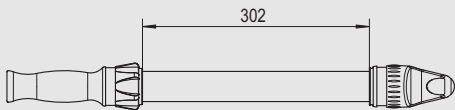
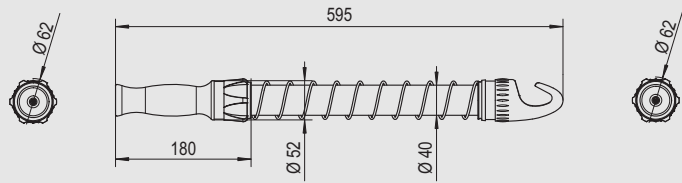
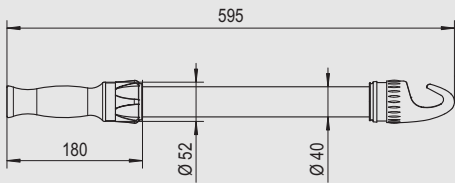

03714E00

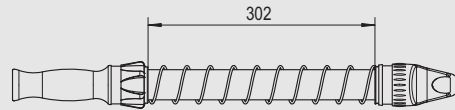

04925E00

Inspection light without wire guard

Inspection light with wire guard

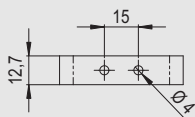

04926E00

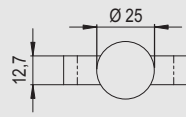

04927E00

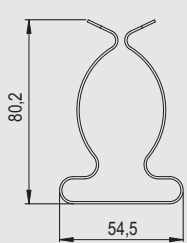

Mounting bracket

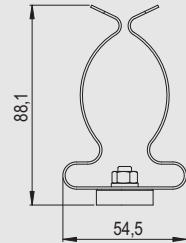

Mounting bracket and magnet

We reserve the right to make alterations to the technical data, weights, dimensions, designs and products available without notice. The illustrations cannot be considered binding.