

# Mounting Instructions

## Optional Fuse Kit

> 6480

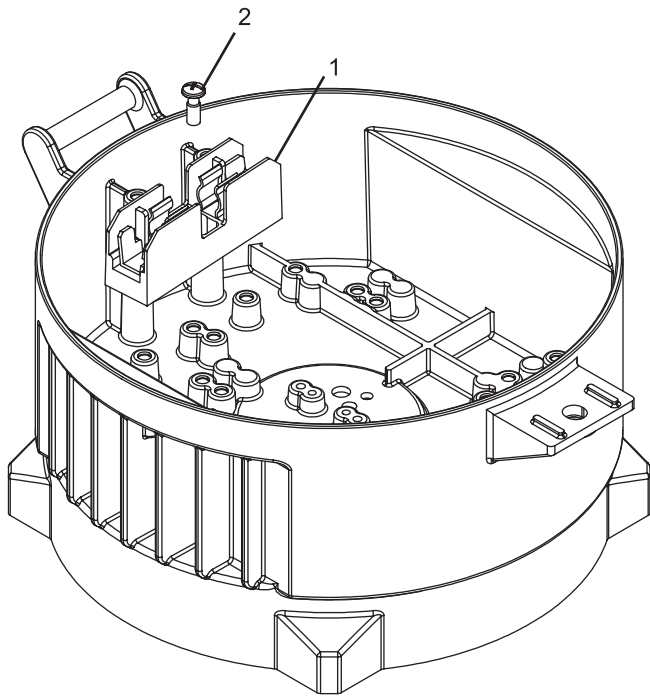

- ▶ Assemble fuse holder (1) in the boss of the castings at marked assigned location in the mount.
- ▶ Fasten fuse holder in casting using self-threading screw (2) provided with kit (tightening torque: 5 N).

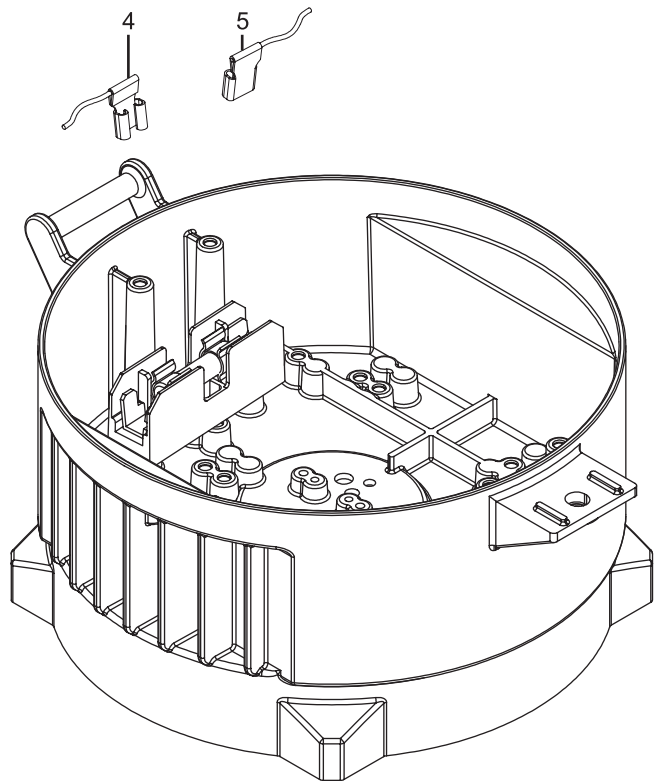

- ▶ Attach supply line (4).
- ▶ Attach ballast line (5).

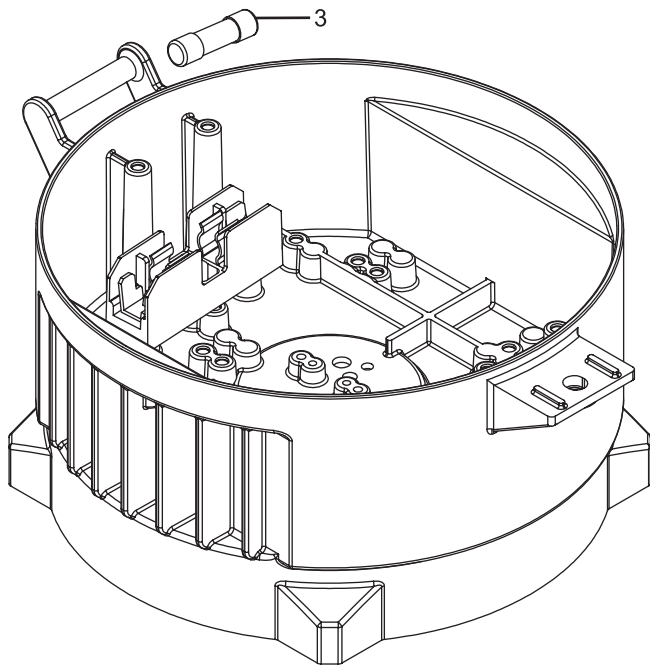

- ▶ Insert fuse (3).